

Installation – Pulse unit MX39 and IR-unit for ext. LCD (SR-4UP + SR-4 EP) on Q4000 meter

1. Lift the lid. Using a small screwdriver blade, carefully remove the pulser clip.
2. Remove the blank cover by lifting it up...
3. and then slide out
4. Fit the pulser/IR-unit unit in the opposite manner to the cover removal*
WARNING: Take care not to dislodge the rubber gasket on the underside of the unit when fitting/removing
5. Replace the securing clip
WARNING: lugs uppermost

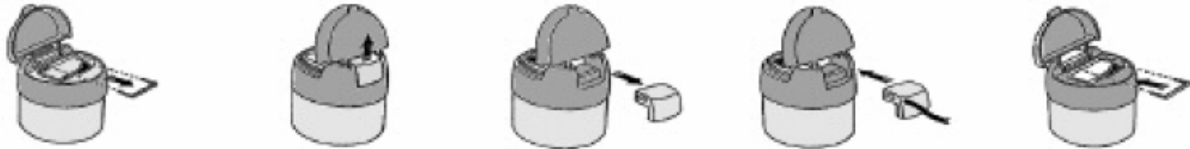

Cable connection – pulse unit MX39

1. Casing pulse unit MX39
2. Type marker
(pulse version – for more details please see data sheet)
3. Cable
4. Wires
 - Red = Pulse output/channel 1
 - White = Pulse output/channel 2
 - Black = Alarms
 - Green = Common

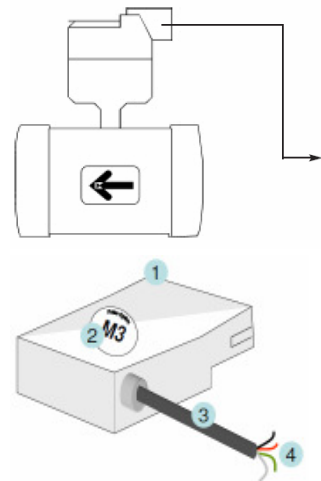

Cable connection – external LCD (SR-4UP + SR-4 EP)

To access the wiring connections, remove the front cover by sliding up and off. Wiring details are shown on the back of the front cover. You can fix the lid by using a small screw.

The type marker you will find on the back of the LCD (pulse output version - for more details please see data sheet)

1. White wire from IR-unit
2. Black wire from IR-unit
3. Output/channel 1 (+)
4. Output /channel 1 (-)
5. Output /channel 2 (-)
6. Output /channel 1 (+)
7. not used
8. not used

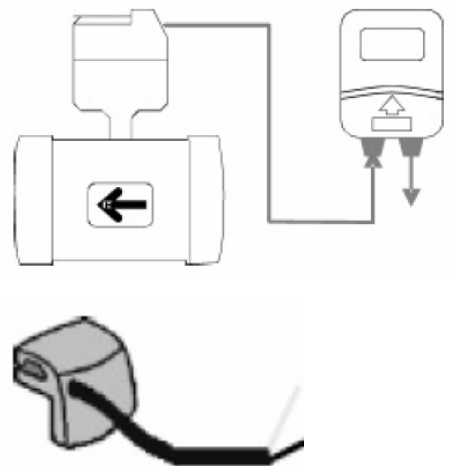

Wiring & Connection Details								
Number	1	2	3	4	5	6	7	8
Colour of wire	White	Black						
Mark	+	-	+	-(Common)	+			
Description	Meter Input	Pulse Output 1	Pulse Output 2					NC